

Equipment Technical Bulletin

Release of New Version 2 BetaJet



PROBLEM(S)

1. The original BetaJet was difficult to open.
2. For a small number of accounts, the red clips shot off the unit while connected to water supply via copper tubing (which is subject to water hammer).

SOLUTION

Beta has created a new version of BetaJet with improved, updated components. The effected part numbers are:

Description	Old version mach 1 Code#	New version mach 2 Code#
BetaJet R-Gap Low Flow (RGLF)	1200655	1203878
BetaJet R-Gap High Flow (RGHF)	1200654	1203877
BetaJet A-Gap Low Flow (AGLF)	1200653	1203876
BetaJet A-Gap High Flow (AGHF)	1200652	1203875

The wishbone, interconnect, water inlet fitting, water inlet plug fitting, water strainer and strainer sock have not changed, and can be used on either version. **All other parts have changed and are incompatible with version 1.** Contact Customer Service if version 1 spares are required.

Modified Parts Summary

Cover, graphics band and C-clip: The new cover and graphics band have been molded with guides to position the C-clip for easier opening. The new C-clip has tapered (rather than flat) ends.

- On version 1, after inserting the C-clip the cover had to be pushed slightly while pressing the C-clip up toward the top of the proportioner.
- Version 2 is more intuitive; once the C-clip is pushed into place, the cover is already unlatched and can be removed with the C-clip in it. To reassemble, simply remove the C-clip.

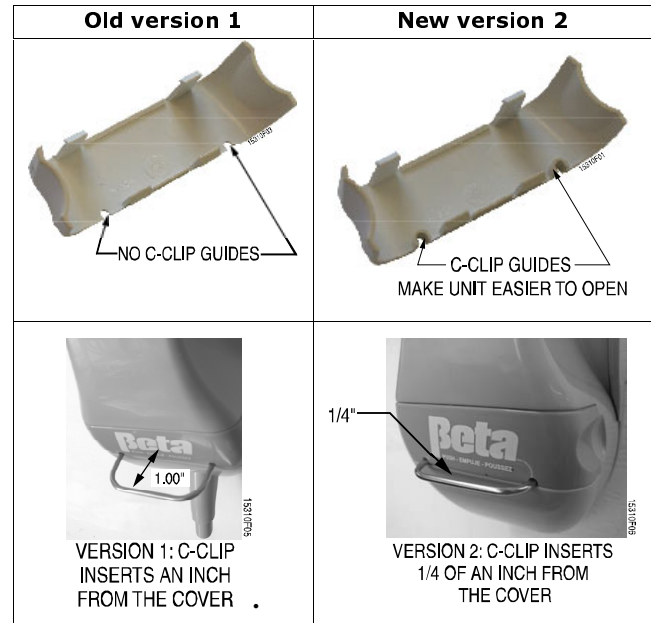

- *Version 1 C-clips can be used on version 2 units, but they may damage the backplate*
- *Version 1 graphics bands can be used on version 2 units, but the unit will be more difficult to open.*

On/off valve and colored clips: The valve and clips were changed so water hammer can not make the clips shoot off. Valve disk tabs were added so you just twist the valve disk to change from momentary push on to lock on/lock off activation.

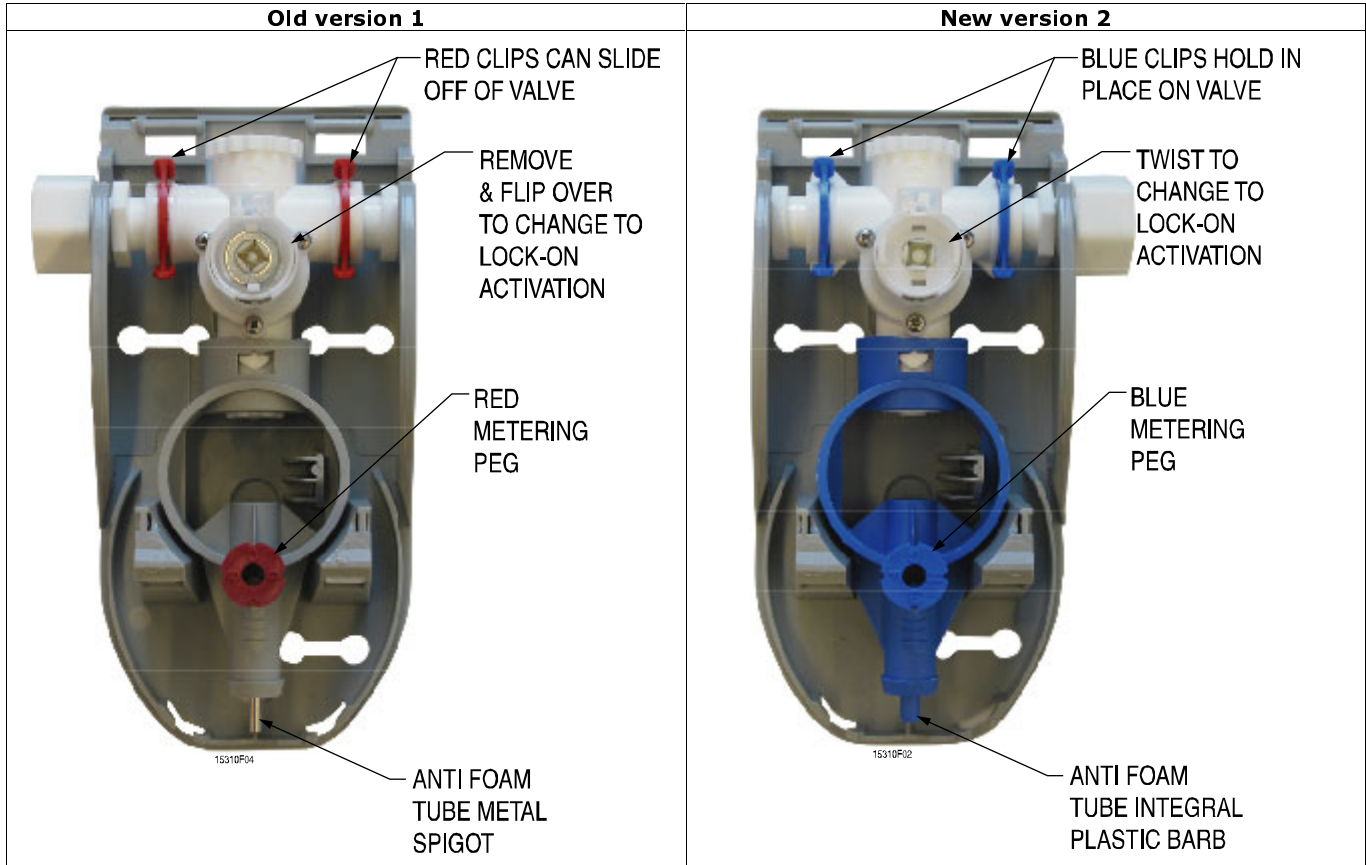

Metering pegs: Version 1 BetaJets used three red pegs, while version 2 uses four blue pegs, giving you more dilution settings across roughly the same dilution range. There are still 4 dilution settings per peg.

Ultradilution kits: version 1 ultradilution kit prototypes will not fit into version 2 units. The soon-to-be-released version 2 ultradilution kit can be used with either version 1 or version 2 units.

Anti-foam tubes: On the A-Gap Low-Flow units these tubes now attach directly to a small plastic barb rather than a metal barb.

Installation sheet: Version 2 includes a new dilution chart showing the effect of viscosity on dilutions, so reps have a better idea what settings to start out with when calibrating dilutions for viscous chemicals.



Beta Technology
2841 Mission Street
Santa Cruz • CA
U.S.A. • 95060

TEL • 831 • 426 • 0882
TEL • 800 • 858 • 2382
FAX • 831 • 423 • 4573
FAX • 800 • 221 • 8416

Customer Service

TEL (U.S. and Canada) • 800 • 468 • 4893
TEL (outside U.S. and Canada) • 01 • 410 • 228 • 1292

Tech Support

sales@beta-technology.com

Beta Technology

4 Finway, Dallow Road
Luton LU1 1TR
United Kingdom

Freephone • 0800 • 052 • 4726
Tel • +44(0) • 1582 • 528600
Fax • +44(0) • 1582 • 528 111
Freephone • 0800 • 052 • 4726
VAT REG.NO.BG.354 - 09975 - 44

Customer Service

Tech Service

europa.sales@beta-technology.com

<http://www.beta-technology.com>

Beta Technology is ISO 9001 Certified